

## HONSBERG - TURBINE FLOW SENSOR FOR GENERAL APPLICATIONS

RRT-020GM050  
Flow sensor 3/4", PNP, 1-50l/min Brass/Nickel

- For liquids up to 100 bar
- Flow ranges 1-50 l/min, and 2-80 l/min. water
- Connection 3/4"



### Product description

Model RRT is a simple turbine sensor that is highly suitable in all types of industrial applications where the pressure does not exceed 100 bar. The sensor has a low tolerance in terms of pulses and therefore is suitable when used in large numbers.

### Technical specification

<b>Function</b>	Turbine, Hall effect sensor
<b>Supply voltage</b>	5-24 V DC
<b>Power consumption</b>	Max. 10 mA
<b>Output signal</b>	NPN, 3-29 V square-wave or 4-20 mA
<b>Electrical connection</b>	M12x1, 4 pole
<b>IP-class</b>	IP67
<b>Connection</b>	Internal thread 3/4"
<b>Max. deviation</b>	± 3 %
<b>Repeatability</b>	Included in max. deviation
<b>Viscosity</b>	1 cSt (higher viscosity gives changed values)
<b>Max. pressure</b>	GP = 10 bar, GM = 100 bar
<b>Media temperature</b>	Max. + 90 °C
<b>Pressure drop</b>	Approx. 0.3 bar at max. flow
<b>Design</b>	
<b>Material housing</b>	GP = POM, GM = Nickel-plated brass
<b>Turbine</b>	Ultem PEI
<b>Bearings</b>	Toughened ferrite

<b>Seals</b>	NBR
<b>Weight</b>	GP = 0.2 kg, GM = 0.6 kg

**Media**



**Dimensions**

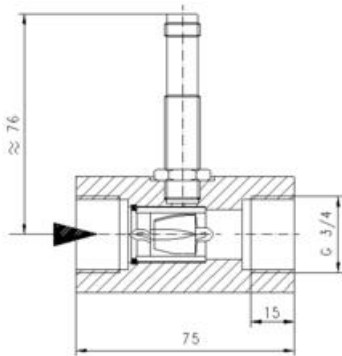

**Installation**

**NPN**

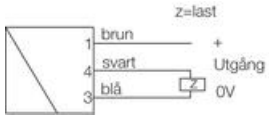

**4-20 mA**

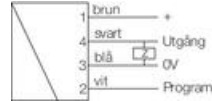

**Order number**

Item no. PNP	Item no. 4-20 mA	Connection G	Flow range l/min. water	Max. flow water l/min.	Pulses/L. ca.
<b>Nickel plated brass</b>					
RRT-020GM050	RRT-020GM050E	3/4	1-50	50	100
RRT-020GM080	RRT-020GM080E	3/4	2-80	80	150
<b>POM</b>					
RRT-020GP050	RRT-020GP050	3/4	1-50	50	100
RRT-020GP080	RRT-020GP080	3/4	2-80	180	150