

## JUNG HYGHSPIN HOPPER SERIES PUMP

Hygienic twin screw pump

JPS HYGHSPIN 70H



- Flow 100l/h to 30m<sup>3</sup>/h
- Pressure up to 25 bar
- Viscosity up to 50,000,000 cSt
- Temperature -10°C to +130°C (160°C)
- Max. particle size 45mm

### Product description

The HYGHSPIN Hopper is an addition to the worldwide tried and tested HYGHSPIN series of Twin Screw Pumps made of stainless steel. The innovative twin screw pump with a funnel opening is capable of transporting products with viscosities of up to 1000 Pas. Its conveyor screws are extended so that they can induct non-flow capable products below the inlet funnel in a similar principle to an extruder and then feed them into the pump chamber. This ensures a particularly gentle handling - an external extruder can be completely dispensed with.

The HYGHSPIN Hopper therefore provides a very attractive 3-in-1 solution: Feeding, conveying and cleaning take place in only one component. It is available in block design or with free shaft end.

### Specifications

<b>Connection</b>	Different sizes and connector standards by arrangement
<b>Differential Pressure</b>	20 bar
<b>Flow max m<sup>3</sup>/h Double</b>	10
<b>Maximum diameter of solid material</b>	20
<b>Pump orientation</b>	Horizontal, vertical or lateral
<b>Temperature range from</b>	-10
<b>Temperature range to</b>	180
<b>Viscosity</b>	0.5 - 1,000,000 mPas

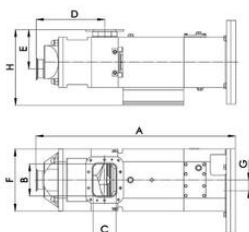

Pumpstørrelse	A	B	C	D	E	F	G	H	I	Højde (Averl)	Vægt
70 Hopper	613mm	98mm	43mm	211mm	175mm	199mm	35mm	272mm	DN65 DN100 (2 1/2" 4")	700g	
90 Hopper	814mm	134mm	93mm	278mm	164mm	259mm	45mm	317mm	DN80 DN150 (3" 6")	1395g	
125 Hopper	1060mm	183mm	123mm	394mm	203mm	348mm	62,5mm	419mm	DN100 DN200 (4" 8")	3320g	