

# KUEBLER - ABSOLUTE-CODED ANGULAR TRANSMITTER SENDIX M3668R, MAGNETIC, CANOPEN, Ø36 MM

SERIE M3668R

- Housing diameter Ø36 mm
- CANopen
- Up to IP69K
- Stainless steel



## Product description

Sendix M3668R is a magnetically encoded absolute encoder with the latest in multi-field technology with "Energy Harvesting". Energy Harvesting technology is based on magnetic recharging, eliminating both battery and gear.

In addition to multi-color technology, the M3668R has been equipped with extra strong ball bearings and secure attachments, also known as "Safety-Lockplus™".

A unique multifarve pulse sensor with high IP classifications: IP66, IP67 and IP69K, available in stainless steel (V4A).

Please refer to the image below for ordering information.

Order code	8.M3668R.XX2X.2122					
Shaft version	Type	a	b	c	d	e
<b>a</b> Version		<b>1 = standard</b> <sup>1)</sup>		<b>c</b> Interface / power supply		<b>e</b> Fieldbus profile
		clamping flange ø 42 mm [1.65"]		<b>2 = CANopen DS301 V4.2 / 10 ... 30 V DC</b>		<b>21 = CANopen</b>
		7 = stainless steel V4A <sup>2)</sup>		<b>d</b> Type of connection		Optional on request
		clamping flange ø 42 mm [1.65"]		2 = radial cable, 1 m [3.28'] PVC		- Ex 2/22 (only for connection type 4)
		all metal parts accessible from outside		B = radial cable, special length PVC *)		- other shaft diameters out of V4A
		are out of stainless steel V4A		<b>4 = radial M12 connector, 5-pin</b>		stainless steel
<b>b</b> Shaft (ø x L), with flat		1 = ø 6 x 12.5 mm [0.24 x 0.49"]		*) Available special lengths (connection type B):		
		<b>3 = ø 8 x 15 mm [0.32 x 0.59"]</b>		2, 3, 5, 8, 10, 15 m [5.56, 9.84, 16.40, 26.25, 32.80, 49.21']		
		5 = ø 10 x 20 mm [0.39 x 0.79"]		order code expansion .XXXX = length in dm		
		2 = ø 1/4" x 12.5 mm [0.49"]		ex.: 8.M3668.132B.2122.0030 (for cable length 3 m)		
		E = ø 10 x 20 mm [0.39 x 0.79"], stainless steel V4A				

## Specifications

Housing diameter	36
IP Class	IP66, IP67, IP69K
Resolution More Yards	Max. 24 bit
Shaft Diameter max	10
Shaft Diameter min	6
Supply Voltage DC Max	30
Supply Voltage DC Min	10

Temperature range from

-40

Temperature range to

85

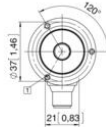
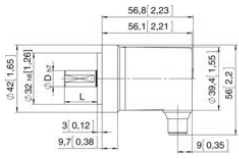

Interface	Type of connection	Cable (isolate unused wires individually before initial start-up)					
2	2.8	Signal	+V	0V	CAN_GND	CAN_H	CAN_L
		Cable colour:	BN	WH	GY	GA	YE

Interface	Type of connection	M12 connector, 5-pin					
2	4	Signal	+V	0V	CAN_GND	CAN_H	CAN_L
		Pin:	2	3	1	4	5

Top view of mating side, male contact base



M12 connector, 5-pin