

KUEBLER - ABSOLUTE-CODED ANGULAR TRANSMITTER SENDIX M3668 / M3688, MAGNETIC, CANOPEN, Ø36 MM SERIE M3668

- Housing diameter Ø36 mm
- CANopen
- New multicolor technology
- IP67



Product description

Please refer to the images below for ordering information.

Order code	8.M3668					X	X	2	X	.	21	2	2
Shaft version	Type	a	b	c	d	e							
a Flange	1 = clamping flange, IP67, ø 36 mm [1.42"] 3 = clamping flange, IP65, ø 36 mm [1.42"] 2 = synchro flange, IP67, ø 36 mm [1.42"] 4 = synchro flange, IP65, ø 36 mm [1.42"]	c Interface / power supply	2 = CANopen DS301 V4.2 / 10 ... 30 V DC		e Fieldbus profile	21 = CANopen							
b Shaft (ø x L), with flat	1 = ø 6 x 12.5 mm [0.24 x 0.49"] 3 = ø 8 x 15 mm [0.32 x 0.59"] 5 = ø 10 x 20 mm [0.39 x 0.79"] 2 = ø 1/4" x 12.5 mm [0.49"]	d Type of connection	1 = axial cable, 1 m [3.28'] PVC A = axial cable, special length PVC *) 2 = radial cable, 1 m [3.28'] PVC B = radial cable, special length PVC *) 3 = axial M12 connector, 5-pin 4 = radial M12 connector, 5-pin		Optional on request - Ex 2/22 (only for connection types 3 and 4) - surface protection salt spray tested								
		*) Available special lengths (connection types A, B): 2, 3, 5, 8, 10, 15 m [5.56, 9.84, 16.40, 26.25, 32.80, 49.21'] order code expansion .XXXX = length in dm ex.: 8.M3668.432A.2122.0030 (for cable length 3 m)											

Order code	8.M3688					X	X	2	X	.	21	2	2
Hollow shaft	Type	a	b	c	d	e							
a Flange	2 = with stator coupling, IP65, ø 46 mm [1.81"] 3 = with spring element, long, IP65 5 = with stator coupling, IP67, ø 46 mm [1.81"] 6 = with spring element, long, IP67	c Interface / power supply	2 = CANopen DS301 V4.2 / 10 ... 30 V DC		e Fieldbus profile	21 = CANopen							
b Blind hollow shaft (insertion depth max. 18.5 mm [0.73"])	1 = ø 6 mm [0.24"] 3 = ø 8 mm [0.32"] 4 = ø 10 mm [0.39"] 2 = ø 1/4"	d Type of connection	1 = axial cable, 1 m [3.28'] PVC A = axial cable, special length PVC *) 2 = radial cable, 1 m [3.28'] PVC B = radial cable, special length PVC *) 3 = axial M12 connector, 5-pin 4 = radial M12 connector, 5-pin		Optional on request - Ex 2/22 (only for connection types 3 and 4) - surface protection salt spray tested								
		*) Available special lengths (connection types A, B): 2, 3, 5, 8, 10, 15 m [5.56, 9.84, 16.40, 26.25, 32.80, 49.21'] order code expansion .XXXX = length in dm ex.: 8.M3688.242A.2122.0030 (for cable length 3 m)											

Specifications

Housing diameter	36
IP Class	IP65, IP67

Resolution More Yards	24 bit
Shaft Diameter max	10
Shaft Diameter min	6
Supply Voltage DC Max	30
Supply Voltage DC Min	10
Temperature range from	-40
Temperature range to	85

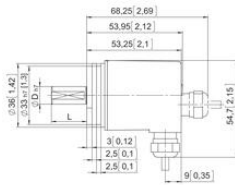
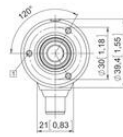
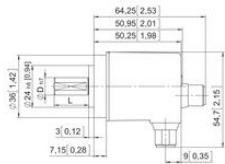

Interface	Type of connection	Cable (update uncoiled wires individually before initial start-up)	Signal	VV	0V	CAN_GND	CAN_H	CAN_L
2	1-2-A-B		Signal					
	Cable colour	BR	WH	GY	GN	YE		

Interface	Type of connection	M12 connector type	Signal	VV	0V	CAN_GND	CAN_H	CAN_L
2	3-4	Pin	Signal	2	3	1	4	5

Top view of mating side, male contact base



M12 connector, 5-pin