

KUEBLER - ABSOLUTE-CODED ANGULAR TRANSMITTER SENDIX 5858/5878, OPTICAL, PROFINET, Ø58 MM SERIE 5858 PROFINET

- Housing diameter Ø58 mm
- ProfiNet
- Safety-Lock™
- High enclosure class



Product description

Sendix 5858/5878 is a one-way fieldbus sensor with ProfiNet in robust design. Thanks to the design of Safety-Lock™ and the fully cast housing, the sensor is able to handle even the more demanding applications where there are high demands on the sensor. The wide temperature range combined with the high enclosure class allows the sensor to be used outdoors as well as applications where large temperature changes occur. Sendix 5858/5878 is available with LED indication, which facilitates diagnosis of the sensor and a set button that facilitates calibration.

Please refer to the images below for ordering information.

Order code	8.5858 . X X C 2 . C2 12				
Shaft version	Type				
	a	b	c	d	e
a Flange	b Shaft (ø x L), with flat		c Interface / power supply		e Field bus profile
1 = clamping flange, IP65 ø 58 mm [2.28"]	1 = 6 x 10 mm [0.24 x 0.39"] ¹⁾		C = PROFINET IO / 10 ... 30 V DC		C2 = PROFINET IO
3 = clamping flange, IP67 ø 58 mm [2.28"]	2 = 10 x 20 mm [0.39 x 0.79"] ²⁾		d Type of connection		Optional on request
2 = synchro flange, IP65 ø 58 mm [2.28"]	3 = 1/4" x 7/8"		removable bus terminal cover		- Ex 2/22
4 = synchro flange, IP67 ø 58 mm [2.28"]	4 = 3/8" x 7/8"		2 = 3 x M12 connector, 4-pin		- surface protection salt spray tested
5 = square flange, IP65 □ 63.5 mm [2.5"]					
7 = square flange, IP67 □ 63.5 mm [2.5"]					

Order code	8.5878 . X X C 2 . C2 12				
Hollow shaft	Type				
	a	b	c	d	e
a Flange	b Blind hollow shaft		c Interface / power supply		e Field bus profile
1 = with spring element, long, IP65	(insertion depth max. 30 mm [1.18"])		C = PROFINET IO / 10 ... 30 V DC		C2 = PROFINET IO
2 = with spring element, long, IP67	3 = ø 10 mm [0.39"]		d Type of connection		Optional on request
3 = with stator coupling, IP65 ø 65 mm [2.56"]	4 = ø 12 mm [0.47"]		removable bus terminal cover		- Ex 2/22
4 = with stator coupling, IP67 ø 65 mm [2.56"]	5 = ø 14 mm [0.55"]		2 = 3 x M12 connector, 4-pin		- surface protection salt spray tested
5 = with stator coupling, IP65 ø 63 mm [2.48"]	6 = ø 15 mm [0.59"]				
6 = with stator coupling, IP67 ø 63 mm [2.48"]	8 = ø 3/8"				
	9 = ø 1/2"				

Specifications

Housing diameter	58
IP Class	IP65, IP67
Shaft Diameter max	10

Shaft Diameter min	6
Supply Voltage DC Max	30
Supply Voltage DC Min	10
Temperature range from	-40
Temperature range to	80

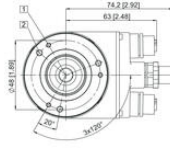
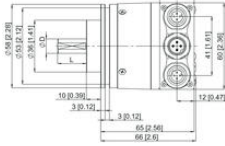
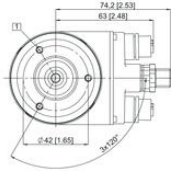
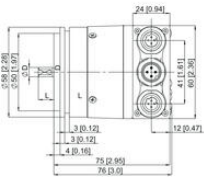

Type of connection 2, Decoded

Direction	A1/Port				Port 2			
	Transmit data	Receive data	Transmit data	Receive data	Transmit data	Receive data	Transmit data	Receive data
Abbreviation	TxD1	RxD1	TxD2	RxD2	TxD2	RxD2	TxD2	RxD2
M12 Pin assignment	1	2	3	4	1	2	3	4

Port A and B



Terminal assignment power supply

Signal	V+ power supply	V- power supply	0V	V- power supply
Abbreviation	V+	-	0V	-
M12 Pin assignment	1	2	3	4

