

## CROUZET SWITCHES - 83 106 DOUBLE BREAKING

83106022  
831060 D/BRK W3

- Breaking and terminating contacts
- Spring-loaded or bistable



### Product description

### Specifications

<b>Allowable Operating Force Max</b>	20
<b>Contact gap</b>	0,4 x 2 mm
<b>Hysteresis Max</b>	0,7
<b>IP Class</b>	IP40
<b>Operating Force Max</b>	4
<b>Over Movement My</b>	0,7
<b>Rated current at 250 V AC</b>	5
<b>Return Movement Force Min</b>	1
<b>Sleep Max</b>	12,75
<b>Switching Point</b>	11,45±0,2-0,25
<b>Temperature range from</b>	-40
<b>Temperature range to</b>	85
<b>Thermal current at 250 V AC</b>	17,5

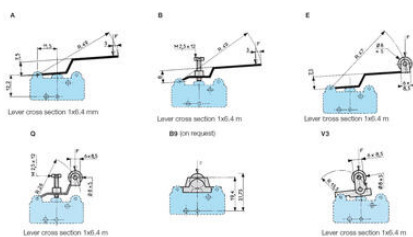

### W3 for 6.35 mm clips

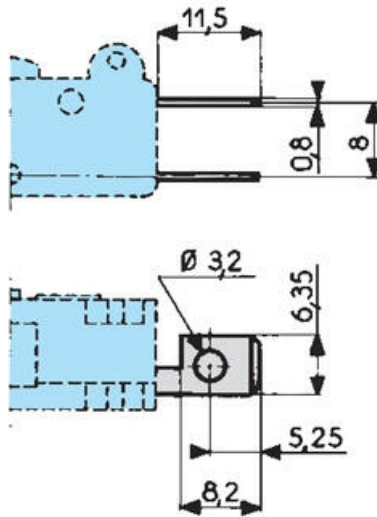

83 106

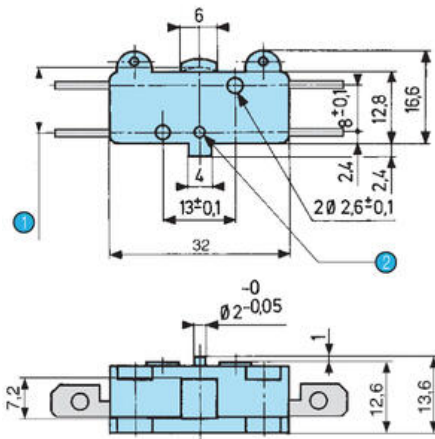

- 1 OL = 10.65
- 2 Ø 2<sup>+0.01 +0.05</sup> depth 1.2

83 106 7

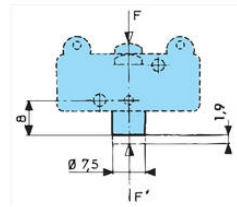

83 106 4

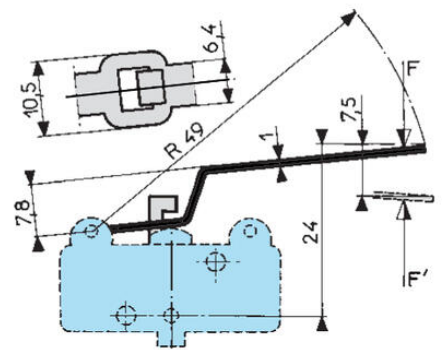

### W1 screw

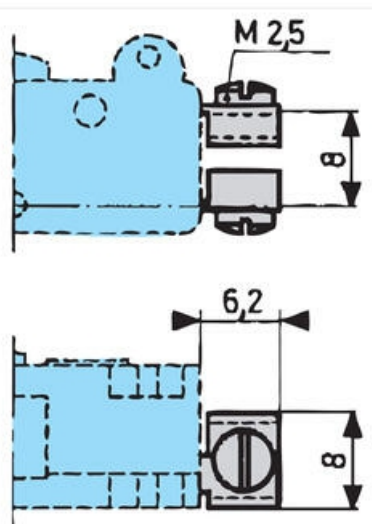

### W2 solder

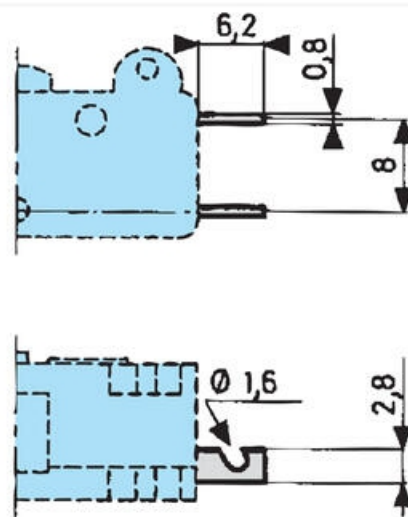

### O2 2-pole side mounting plate

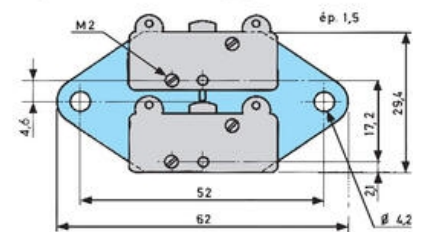

**K2 (on request)**  
**2-pole vertical mounting plate**

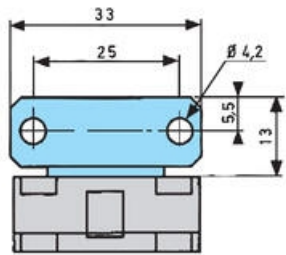
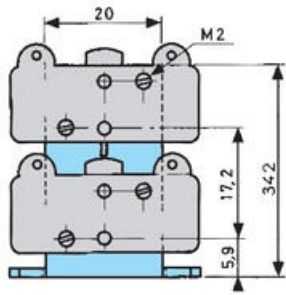

**Y (on request)**  
**side plate**

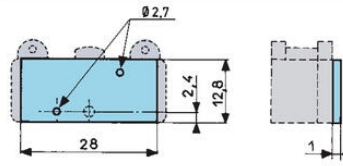

**H**  
**Horizontal single pole mounting plate**

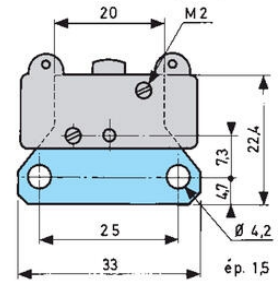

Without indication, the thickness of the plate is 1.5 mm